



Semi-cassette awning

markilux 1600 stretch

The awning with excellent design features and well-thought-out-mechanics. Large projections at limited widths – the perfect solution for narrow reveals, balconies and patios.



product
design award

[markilux.com](https://www.markilux.com)

markilux
safe timeless beautiful

Product characteristics

Wind resistance class 2

Beaufort 5 → 7.5–10.4 m/s → 28–37 km/h → 17–23 mph

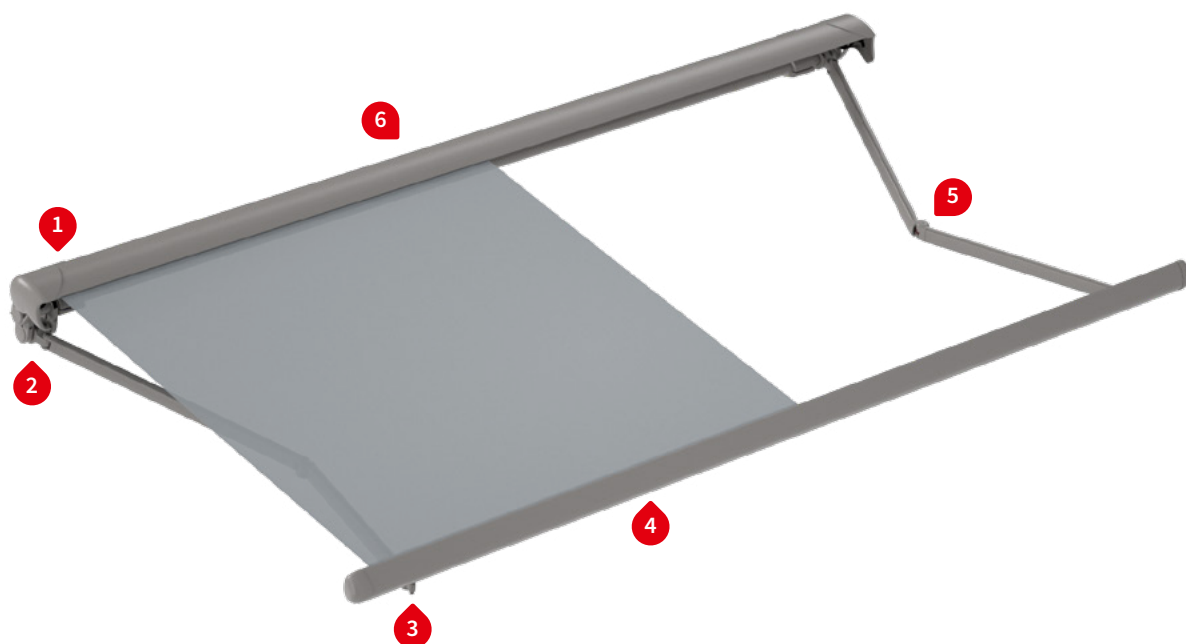

1 face fixture



1 face fixture, maximum pitch 25°



1 top fixture



2 folding arm suspended from the torque bar



3 connection of the lower folding arm to the front profile



4 drop valance 1)

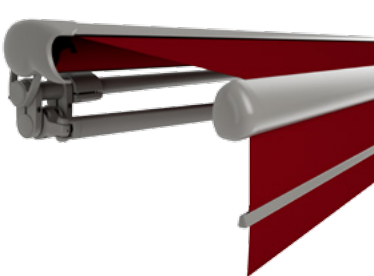

5 twin steel-link chains, corrosion protected



5 bionic tendon made of high-tech fibres for optimum power transfer-ence 1)



6 wall sealing profile up to a pitch of 15° 1)

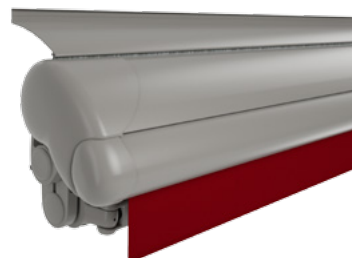

1) optional configuration

Product characteristics

Description

- the folding-arm awning with exceptional, organic design characteristics and pivoting coverboard, ideally suited for shading large areas. The smart engineered arm technology allows shading of areas with more depth than width.

Special features

- awning with an extremely torsion-resistant, round torque bar
- the tiered arms make greater projections than widths possible
- option of a silentec motor – motor noise is appreciably reduced
- during the closing procedure, the coverboard tilts automatically down to meet the given pitch of the awning and together with the front profile encloses the roller tube completely (the awning is open underneath)
- option of a drop valance up to a projection of 350 cm – vertical protection against low-lying sun and inquisitive glances integrated into the front profile, can be operated manually
- coverboard with integrated brush so that debris does not get dragged into the awning as it closes

Dimensions

- awning in standard version: depth 275 mm, height 297 mm
- single unit: minimum width 122 cm at the smallest projection of 150 cm minimum width 247 cm at the largest projection of 400 cm

Roller tube and lateral bearings

- round roller tube Ø 85 mm with keyway, galvanised steel – excellent stability, ensures near perfect cover performance even at the largest widths
- the roller tube support bracket is made of extruded aluminium, powder coated, visually masked by the coverboard end cap

Awning profiles

- extruded aluminium, in façade quality, powder coated
- oval, single-piece coverboard, pre-fitted, enclosing the awning from behind and above
- semi-circular front profile incorporated into the coverboard during closing
- round torque bar Ø 50 mm, galvanised both inside and out, powder coated

Folding arms

- profiles in extruded aluminium, in façade quality, powder coated
- moving parts made of drop-forged aluminium – the arms are therefore extremely fracture resistant
- pivot bolts in stainless steel run in Teflon-coated bronze bushes – practically maintenance free, virtually silent and extremely hard-wearing
- power transference via corrosion-protected twin steel-link chains at the elbow joint, optionally with innovative bionic tendon made of high tensile, high-tech fibres – low in friction, noiseless, insensitive to corrosion and UV resistant

Side caps

- the coverboard end caps are made of high-quality plastic, powder coated
- the front profile and torque bar end caps are made of high-quality plastic, powder coated or in polished chrome

Fixture brackets

- face fixture, top fixture, eaves fixture
- extruded aluminium, powder coated
- pitch adjustment range from 5°–25°; infinitely variable
- spacer plates, stand-off brackets and other accessories are available

Frame and end cap colours

markilux frame colours without surcharge

traffic white RAL 9016



metallic aluminium RAL 9006



grey brown, similar to RAL 8019



off-white textured finish, 5233 ¹⁾



stone grey metallic, 5215 ¹⁾



anthracite metallic, 5204 ¹⁾



Havana brown textured finish, 5229 ¹⁾

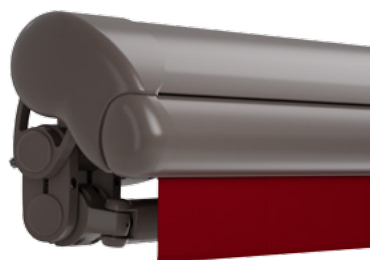

off-white textured finish, 5233 ¹⁾
front profile and torque bar end cap
in polished chrome



stone grey-metallic 5215 ¹⁾
front profile and torque bar end cap
in polished chrome

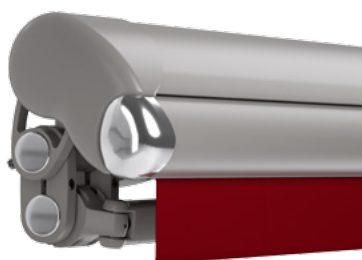

anthracite metallic, 5204 ¹⁾
front profile and torque bar end cap
in polished chrome



Combination options – possible in any frame colour

Non-standard powder-coated finish





Bespoke frame colours at a surcharge – matt, metallic and pearl finishes as well as other colour ranges (DB, Tiger etc.) on request.
All frame colours are available at a surcharge with enhanced corrosion protection

¹⁾ textured finish

Colours may differ slightly from those depicted in both hue and finish.

Dimensions and configuration options

Single unit

Order dimensions		Overall awning width							Minimum width				
		160	185	210	235	260	310	360	410	Motor		Crank handle	
													
		122	161	186	211	236	261	311	361				
		160	185	210	235	260	310	360	410				
H	150	3)		2)	—	—	—	—	—	135	122	139	126
	200	3)			2)	2)	—	—		160	147	164	151
	250	—	3)				2)	—	—	185	172	189	176
	300	—	—	3)				2)	—	210	197	214	201
	350	—	—	—	3)				2)	235	222	239	226
	400 ¹⁾	—	—	—	—	3)				260	247	264	251

1) = drop valance not available

2) = inside dimensions on request

3) = observe the minimum widths!

H = projection

 = 2 folding arms, 2 brackets = 2 standard arms = 2 bespoke arms (surcharge)

dimensions in cm

Operation

	standard	optional
crank handle	✓	—
spring-assisted crank handle	—	✓
Hard-wired motor	—	✓
silentec motor (optionally with an external io / RTS receiver)	—	—
radio-controlled motor io, 868 MHz	—	✓
radio-controlled motor RTS, 433 MHz	—	✓
radio-controlled motor RTS, 433 MHz with manual override	—	✓

Coupled Awning

not available

Awning cover

	fabric range no.	standard	optional
sunvas	301.. / 309..–315..	✓	—
perla	370 ..	—	✓
sunsilk	324.. / 325.. / 328.. / 369..	✓	—
perla FR	374.. / 375..	—	✓
perfortex	331.. / 332..	—	—
transolair	338..	—	—
vuscreen Alu	317..	—	—
Soltis Perform 92	92-20..	—	—
glass fibre screen	272..	—	—
volant, height 25 cm		✓	—

Shadeplus / drop valance

	standard	optional
height 150 cm or 210 cm 1)		
maximum projection 350 cm		
crank handle	✓	—
Hard-wired motor	—	—
radio-controlled motor io, 868 MHz	—	—
radio-controlled motor RTS, 433 MHz	—	—
cover	sunvas / sunsilk / transolair / vuscreen Alu 2)	

1) depending on the fabric width (fabric width 120 cm) with horizontal seam

2) vuscreen Alu: max. height 150 cm

Optional accessories

manual drop valance
folding arm technology with bionic tendon
wall sealing profile (effective up to a maximum awning pitch of 15°)
infrared heater 2000 W / 2500 W
infrared heater 2500 W with integrated radio-controlled receiver 868 MHz io
LED spotline – light bar 110 × 70 mm with 5 W LED spotlights, width 180 cm / 3 spots or 300 cm / 5 spots
LED spotline io – light bar 110 × 70 mm with 5 W LED spotlights with integrated dimmable radio-controlled receiver, width 180 cm / 3 spots or 300 cm / 5 spots
Halogen spotline – light bar 89 mm × 40 mm with 20 W halogen spotlights, 200 cm / 3 spots or 300 cm / 5 spots
automatic controls (light, wind, rain)

N.B! Important background information can be found in the chapter “Optional Accessories”.

Fixture options

wall bracket 100 mm	70867.
spreader plate A 430 × 160 × 12 mm	75326.
spreader plate B 300 × 400 × 12 mm	75325.
stand-off bracket wide 80–300 mm	77968.
top fixture bracket 90 mm	70868.
eaves fixture bracket 90 mm, 150 mm plate	71612.
eaves fixture bracket 90 mm, 270 mm plate	71659.
flat plate and angled bracket for eaves fixture, machine finish aluminium, 500 mm plate	716620
spreader plate 260 × 60 × 12 mm for eaves fixture bracket	75383.
eaves fixture bracket adjustable 7,5°–60°	71198.
angled profile for eaves fixture 100 × 100 × 10 mm, machine finish aluminium, undrilled, by the metre (max. 3 m)	79380.

Bracket fixture range

Awning with 2 folding arms

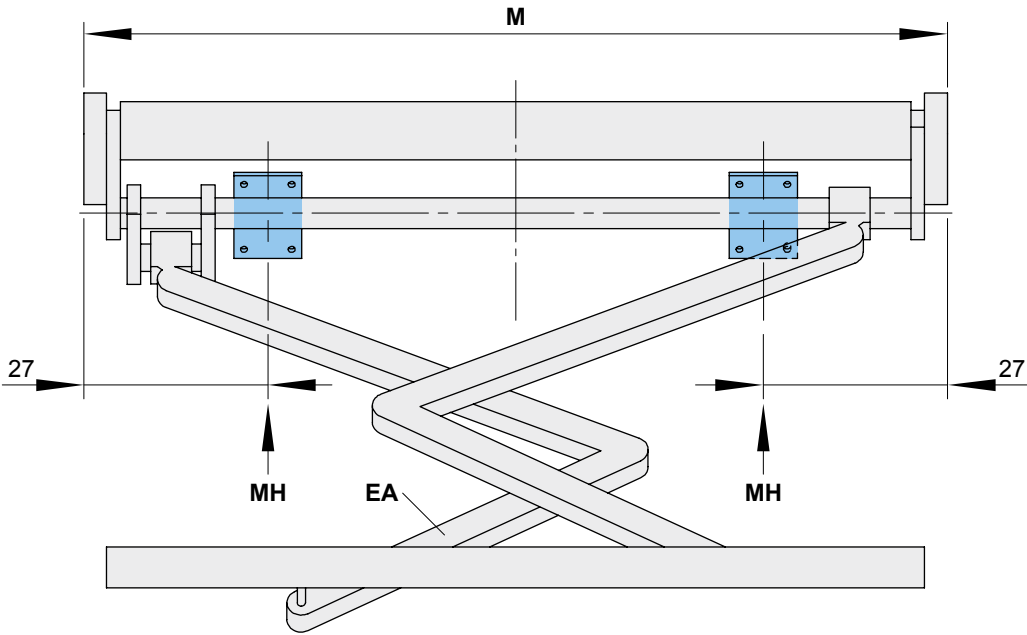

dimensions in cm

		Overall awning width							
		160	185	210	235	260	310	360	410
Order dimensions		122	161	186	211	236	261	311	361
		160	185	210	235	260	310	360	410
BHT		No. of brackets No. of fixing points							
W	10	2 6							
BP		A 2 16 B 2 8							
DE 1)	9	2 8							
DA 1)	9	2 8							

dimensions in cm

- 1) = for information regarding other fixture options, please refer to the section “Pull-out forces” in the online Mediathek at markiluxpro.com
- BHT = bracket width
- BP = spreader plate A or B, to be positioned behind the folding arm
- DA = eaves fixture bracket
- DE = top fixture bracket
- EA = deep folding-arm (opposite of the drive side)
- M = *order dimension* = awning width
- MH = bracket centre
- W = face fixture bracket

Face fixture

Fixtures, fittings and accessories

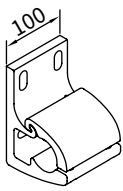

face fixture bracket
100 mm

70867.

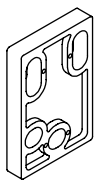

spacer plate for
face fixture
100 × 150 × 20 mm
N.B!
stack to a max. height of
200 mm

718231



spacer plate for
face fixture
100 × 150 × 12 mm

718241

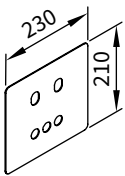

cover plate
for spacer plate
and stand-off brackets
in the case of external
insulation
230 × 210 × 2 mm

71843.

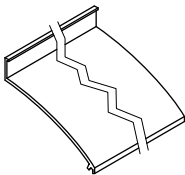

wall sealing profile
available by the metre

77780.

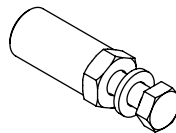

bolt reduction
assembly
pack 10 pcs

M 16 → M 12 | M 16 → M 10 | M 12 → M 10 | M 10 → M 10

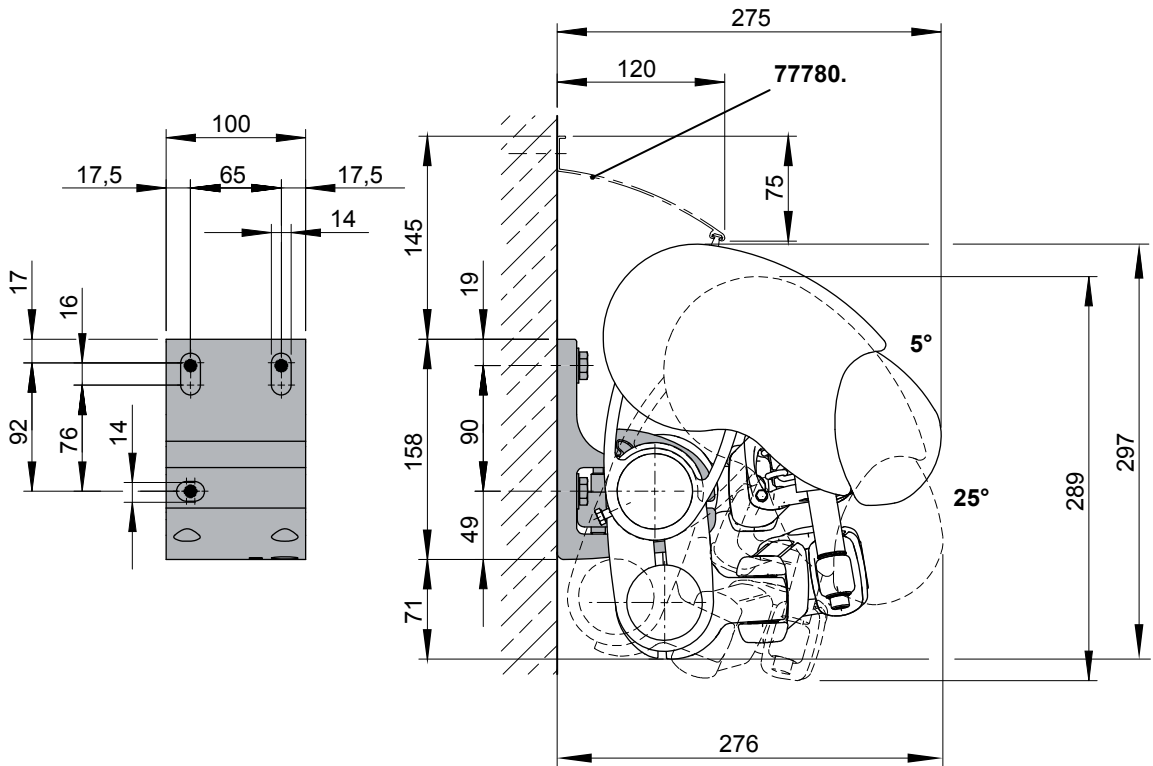

dimensions in mm

Face fixture with spreader plate A

Fixtures, fittings and accessories

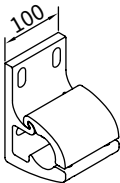

face fixture bracket
100 mm

70867.

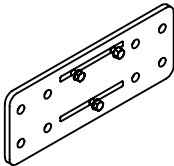

spreader plate A
face fixture
430 × 160 × 12 mm

75326.

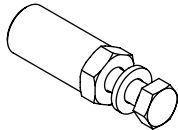

bolt reduction
assembly
pack 10 pcs

M 16 → M 12 | M 16 → M 10 | M 12 → M 10 | M 10 → M 10

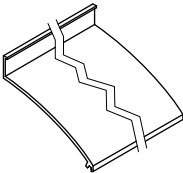

wall sealing profile
available by the metre

77780.

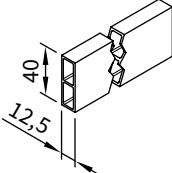

stand-off strip for
wall sealing profile
available by the metre

751971

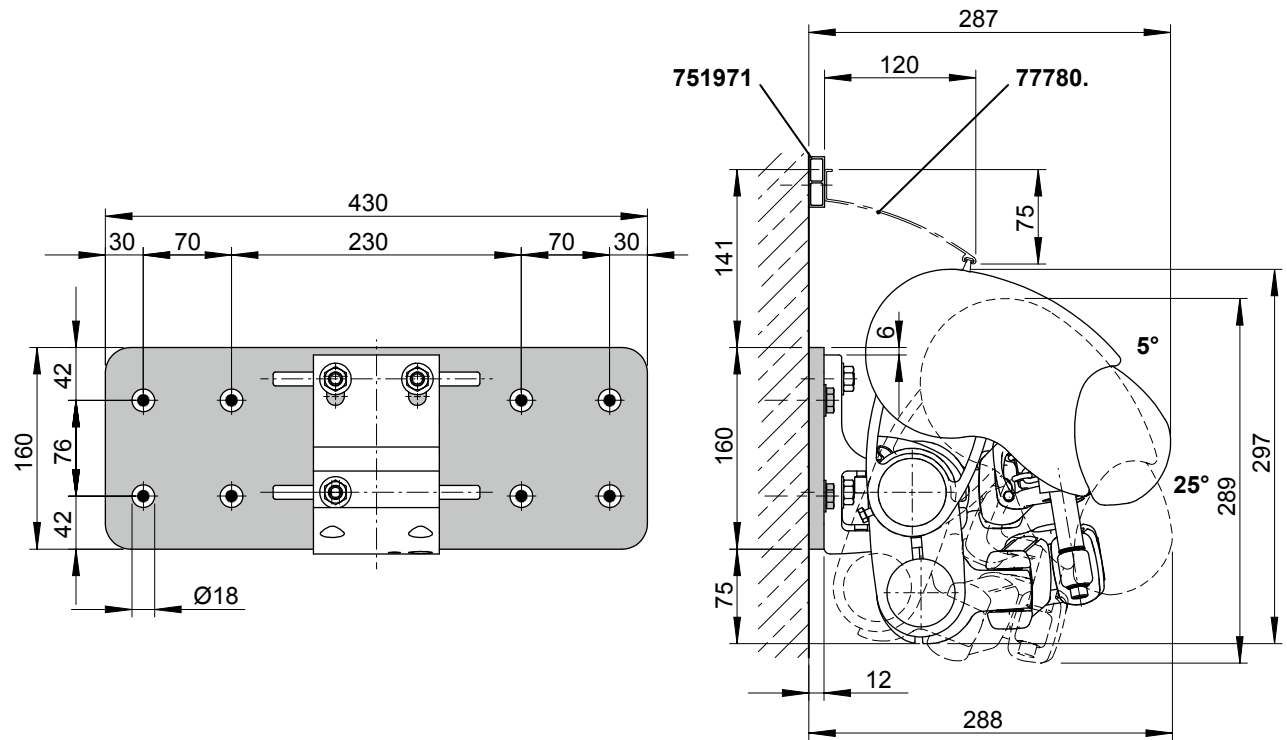

dimensions in mm

Face fixture with spreader plate B

Fixtures, fittings and accessories

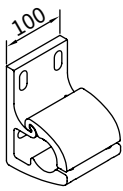

face fixture bracket
100 mm

70867.

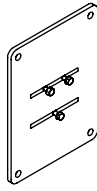

spreader plate B
face fixture
300 × 400 × 12 mm

75325.

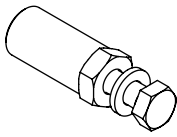

bolt reduction
assembly
pack 10 pcs

M 16 → M 12 | M 16 → M 10 | M 12 → M 10 | M 10 → M 10

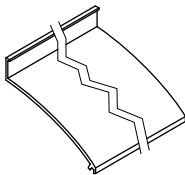

wall sealing profile
available by the metre

77780.

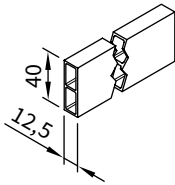

stand-off strip for
wall sealing profile
available by the metre

751971

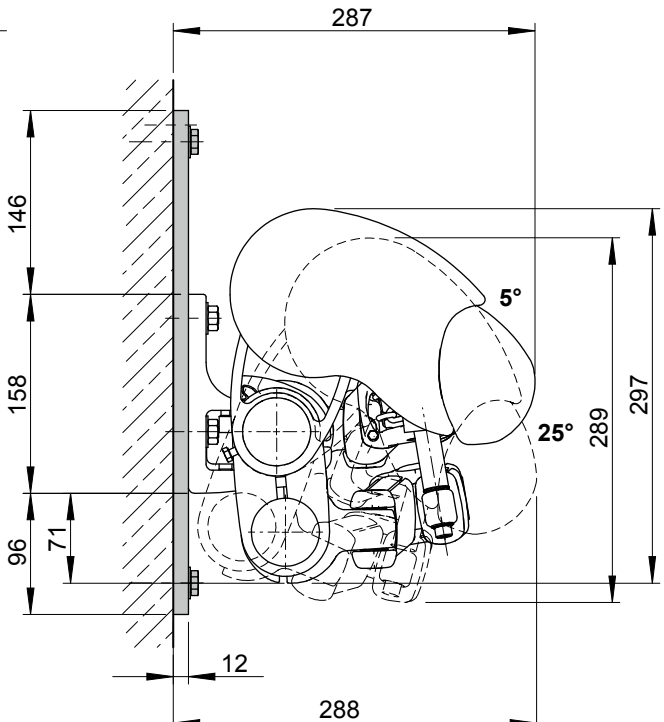
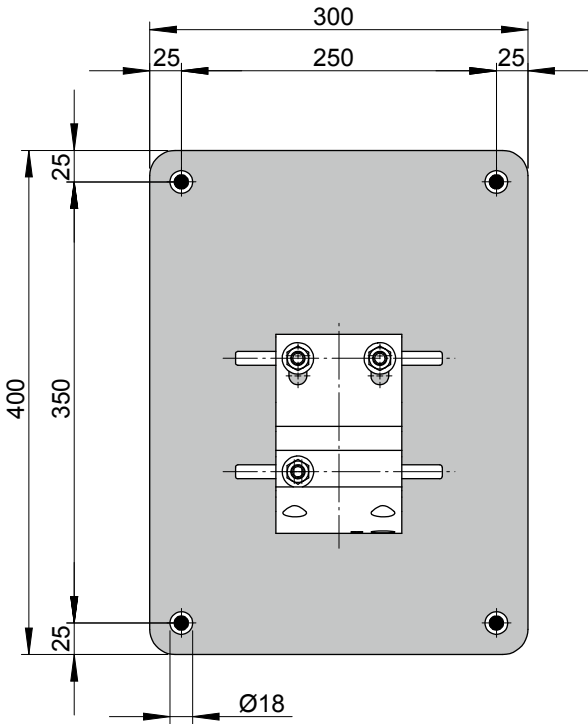

dimensions in mm

Face fixture with stand-off bracket

Fixtures, fittings and accessories

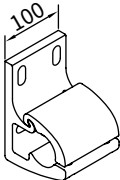

face fixture bracket
100 mm

70867.

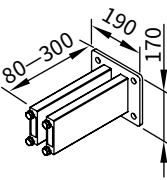

stand-off bracket
for face fixture bracket
70867.

77968.

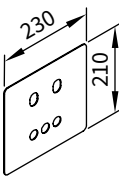

cover plate
for spacer plate
and stand-off brackets
in the case of external
insulation

230 × 210 × 2 mm

71843.

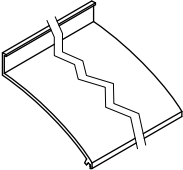

wall sealing profile
available by the metre

77780.

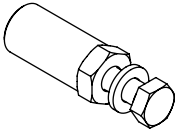

bolt reduction
assembly
pack 10 pcs

M 16 → M 12 | M 16 → M 10 | M 12 → M 10 | M 10 → M 10

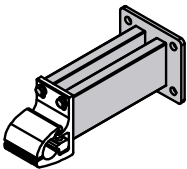

77968.

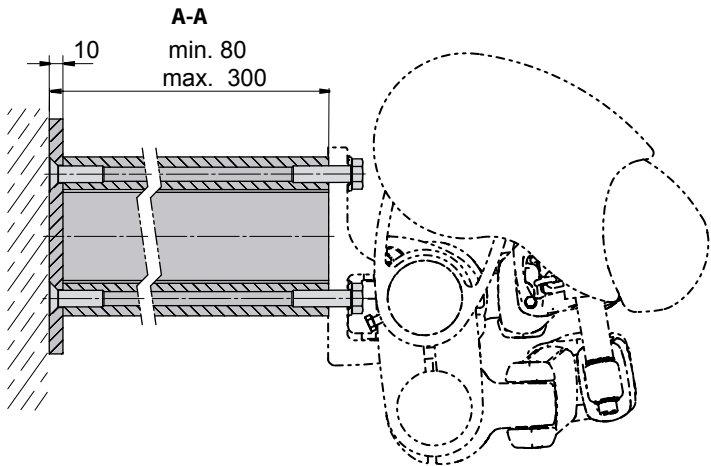
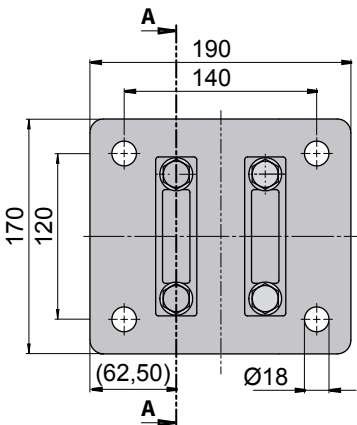

dimensions in mm

Top fixture

Fixtures, fittings and accessories

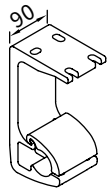

top fixture bracket
90 mm

70868.

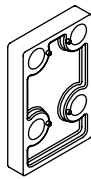

spacer plate for
top fixture
90 × 140 × 20 mm

N.B!
stack to a max. height of
200 mm

716311

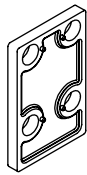

spacer plate for
top fixture
90 × 140 × 12 mm

716411

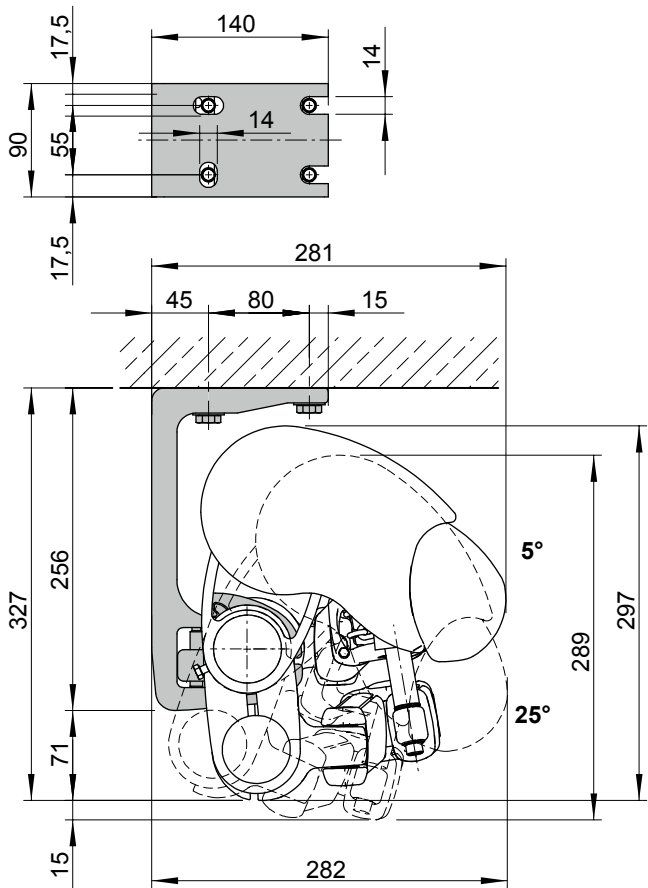

dimensions in mm

Eaves fixture

Fixtures, fittings and accessories

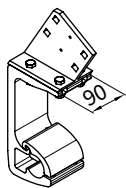

eaves fixture bracket
90 mm

complete set

height of flat
plate: 150 mm

70871.

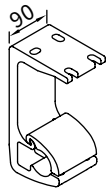

top fixture bracket

90 mm

70868.

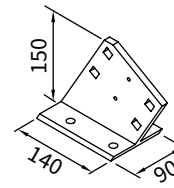

eaves fixture bracket
flat plate

150 mm

71612.

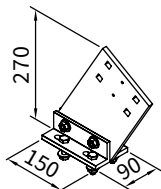

eaves fixture bracket

270 mm plate

please refer to “Eaves
fixture with spreader /
backing plate”

71659.

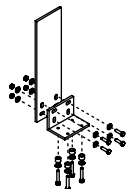

flat plate and angled
bracket for eaves fixture

machine finish

716620

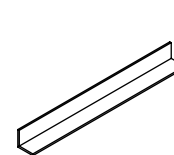

angled profile
eaves fixture bracket
100 mm × 100 mm

sold by the metre,
undrilled
793800 = machine finish

79380.

with eaves fixture bracket flate plate 150 mm (71612.)

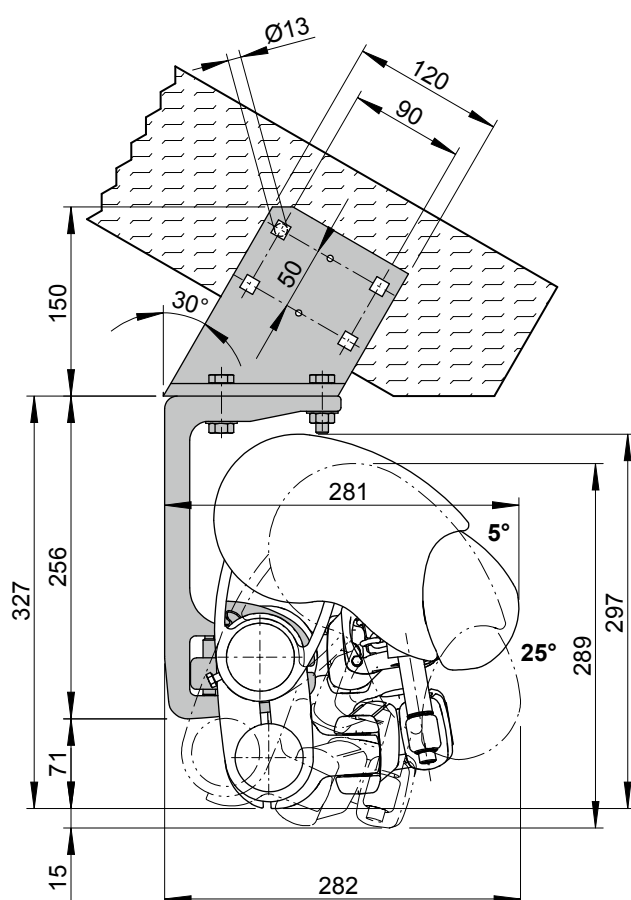

with eaves fixture bracket flate plate 270 mm (71659.)

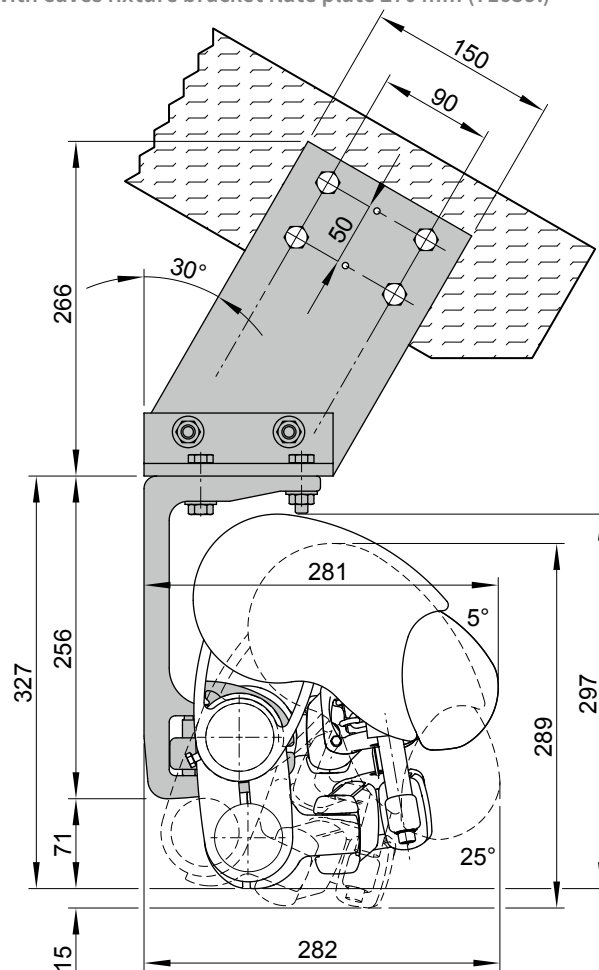

dimensions in mm

Eaves fixture with additional plate

Fixtures, fittings and accessories

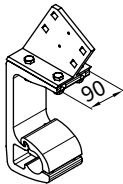

eaves fixture bracket
90 mm
complete set
height of flat plate: 150 mm

70871.

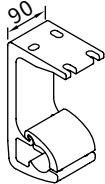

top fixture bracket
90 mm

70868.

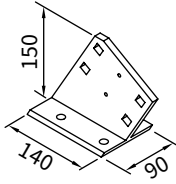

eaves fixture bracket flat plate
150 mm

71612.

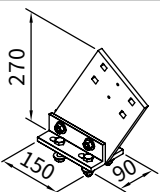

eaves fixture bracket
270 mm plate
please refer to "Eaves fixture with spreader / backing plate"

71659.

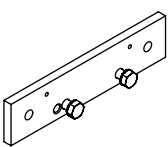

supplementary flat plate eaves fixture
260 × 60 × 12 mm
please refer to "Eaves fixture with spreader / backing plate"

75383.

with eaves fixture bracket 150 mm (70871.)

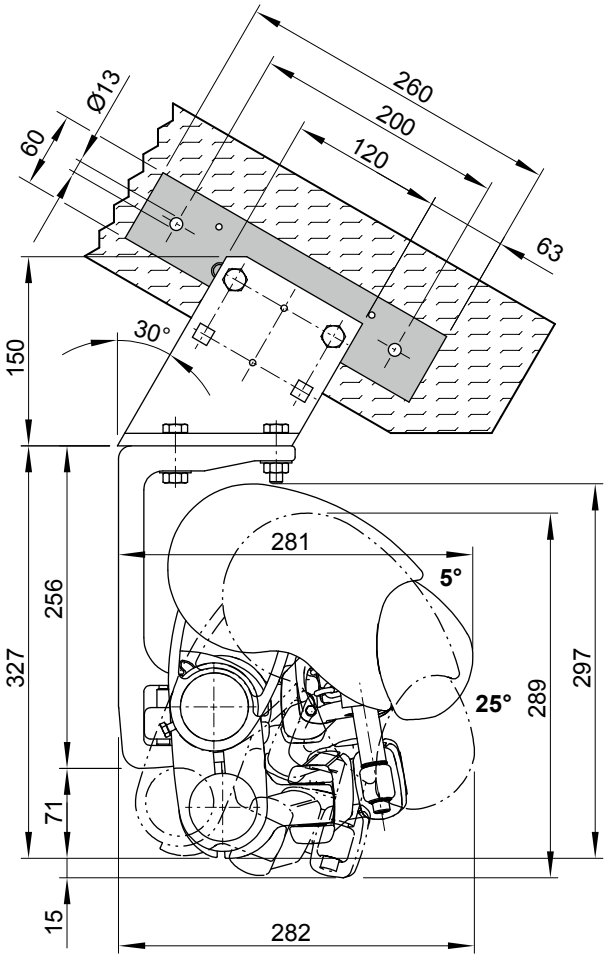

with eaves fixture bracket 270 mm (71659.)

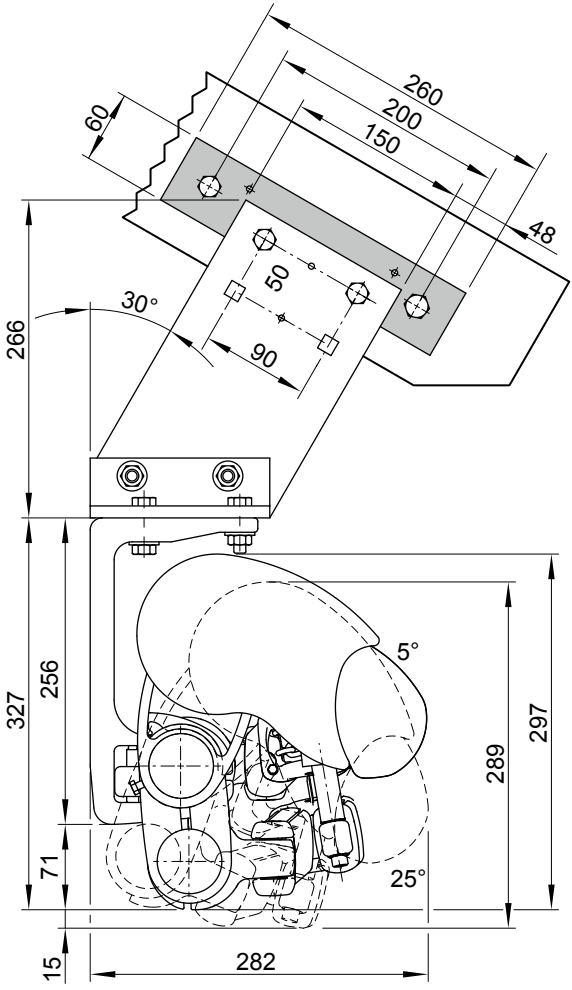

dimensions in mm

Eaves fixture with adjustable bracket

Fixtures, fittings and accessories

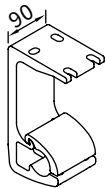

top fixture bracket
90 mm

70868.

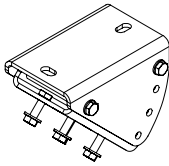

adjustable
eaves fixture bracket

71198.

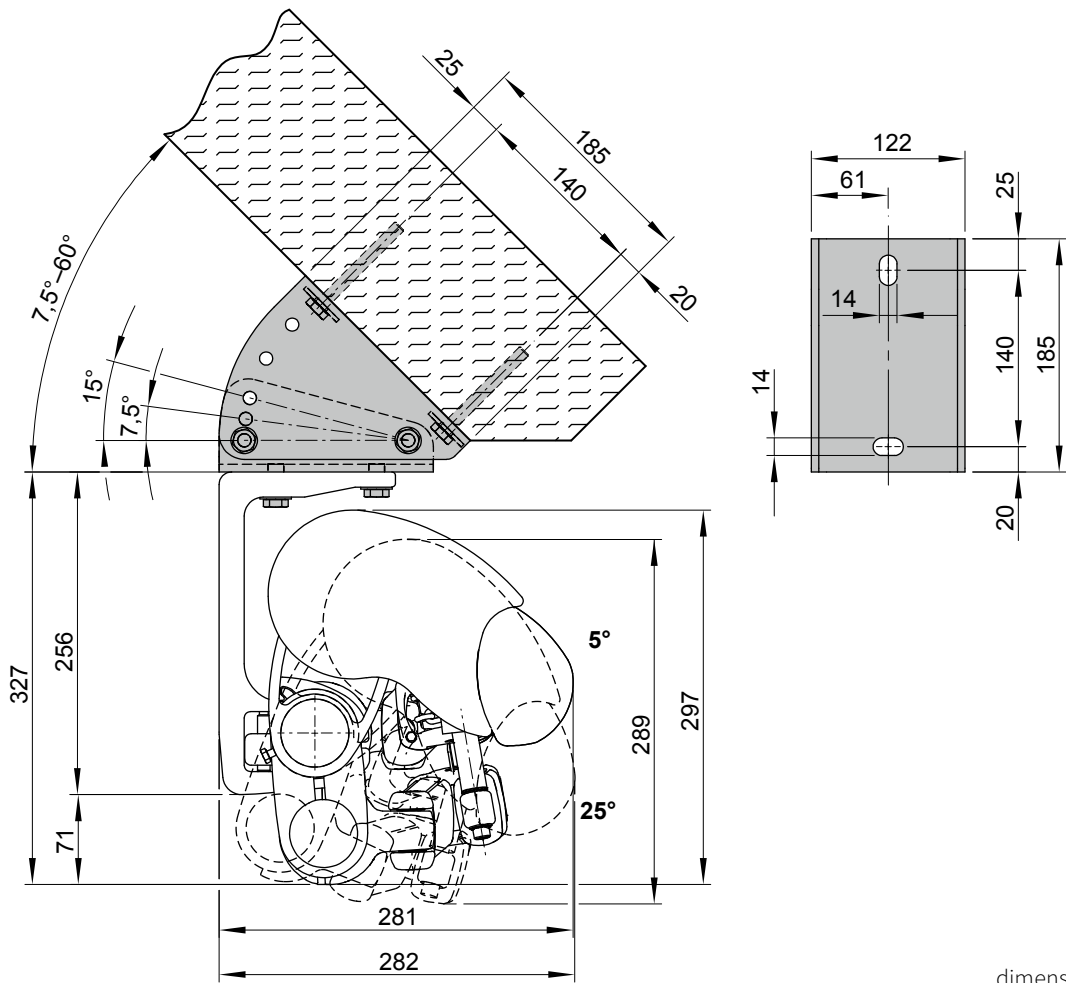

dimensions in mm

Awning with shadeplus

Face fixture

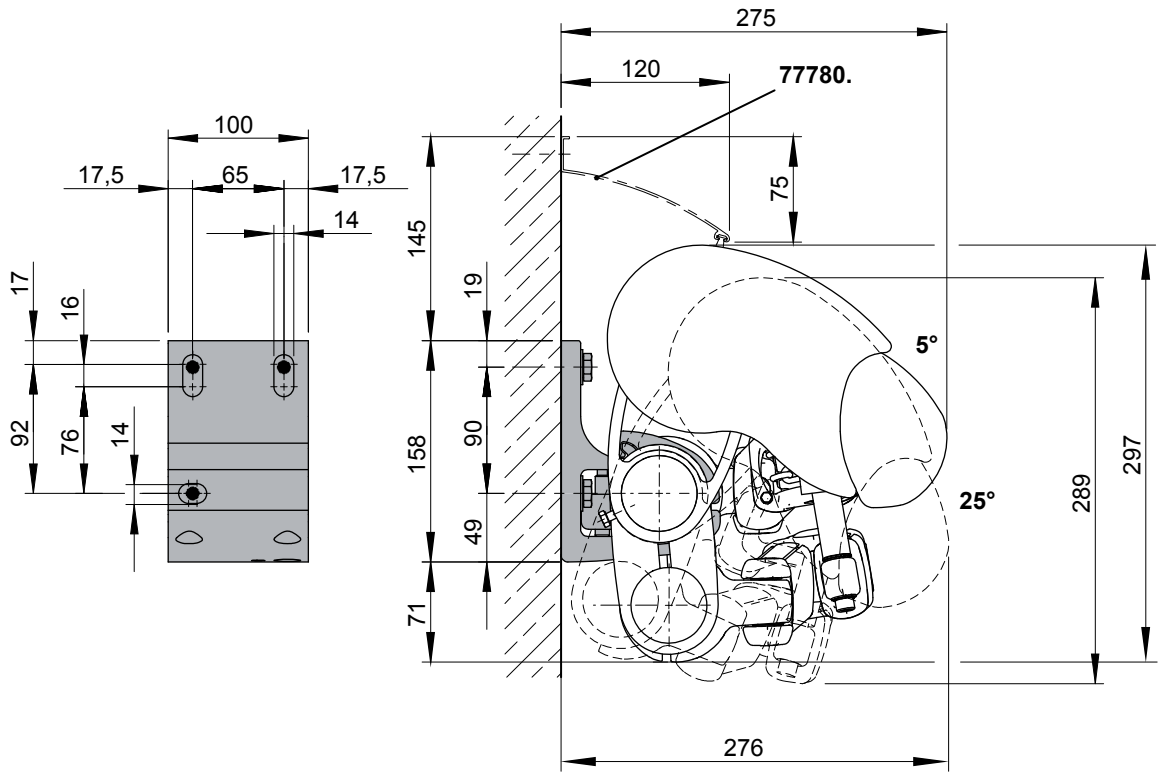

Top fixture

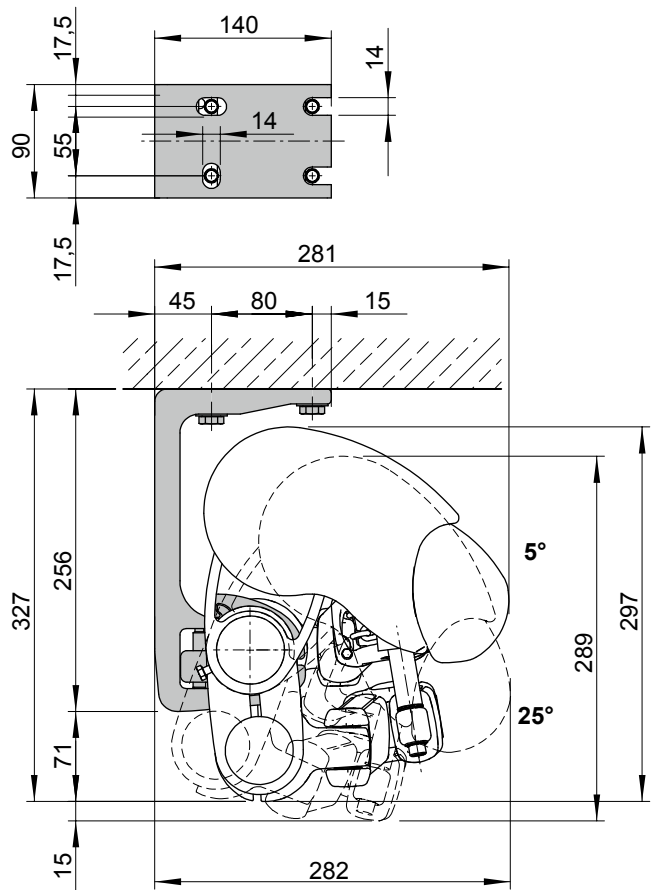

dimensions in mm

Face fixture, manual operation

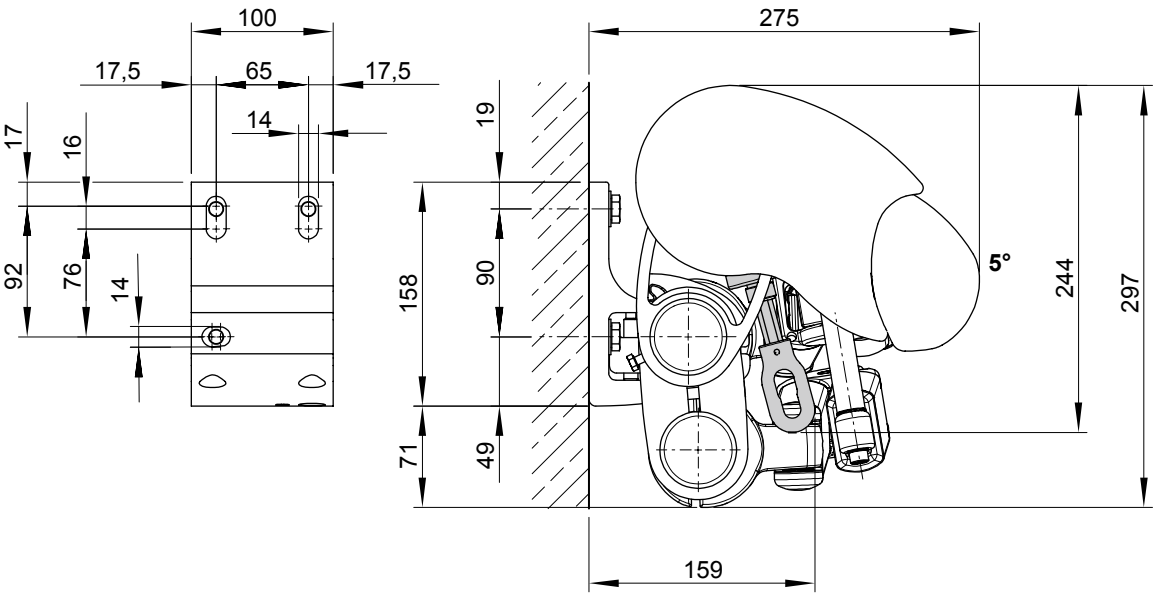

Motor cable exit point

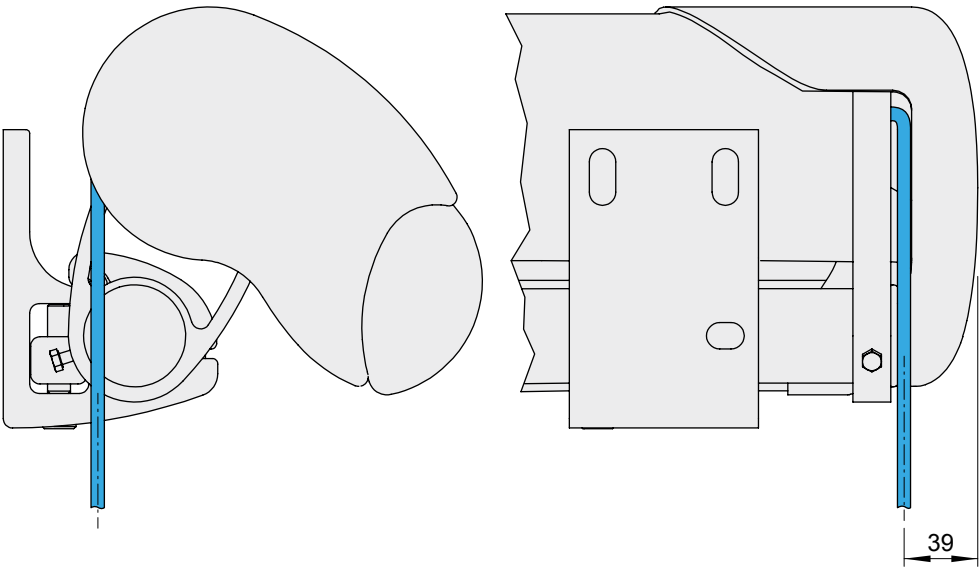

dimensions in mm

Face fixture, radio-controlled motor with manual override

Gearbox eye positions

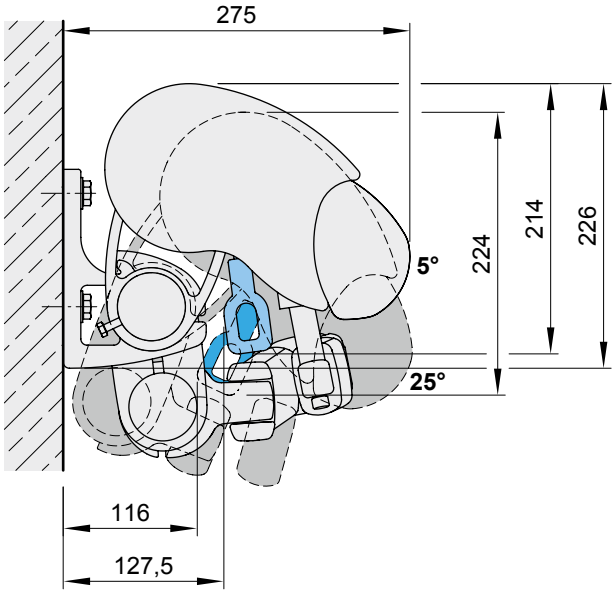

dimensions in mm